

7735...

MINI-BALL DZR

WATER BALL VALVES

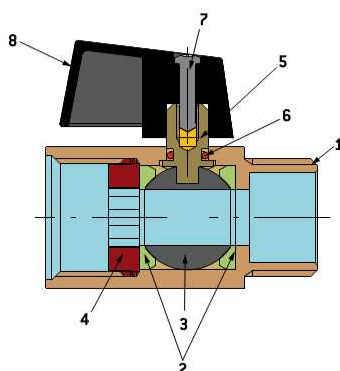

- M/F mini-ball - DZR with lever
- Thread: ISO 228
- Nominal pressure: max 10 bar
- Temperature range: -10°C to $+90^{\circ}\text{C}$

This valve is particularly indicated for distributing and shutting off fluids that can cause dezincification problems.

Excellent fields of application are in plant engineering for plumbing, heating, pneumatic and industry, when it is necessary to have a shut-off element with reduced dimensions.

It is a reduced-bore valve, and ball seal is provided by two PTFE seats.

Seal of the stem is provided by an NBR O-ring with the stem mounted from inside and a bottom-loaded system.

It is advisable to perform a complete manoeuvring cycle at least once every 3 months to prevent the formation of limescale, which would affect operation.

COMPONENTS:

POSN.	PART NAME	No. Pcs.	MATERIAL
1	Body	1	CW602N UNI-EN 12165 Chrome-plated
2	Seal	2	PTFE
3	Ball	1	CW602N UNI-EN 12165 Nickel-plated
4	Ring	1	CW602N UNI-EN 12165
5	Stem	1	CW602N UNI-EN 12165 Nickel-plated
6	O-ring	1	NBR
7	Screw	1	CIR UNI 947-72
8	Black plastic lever	1	Glass- charged nylon 66

DIMENSIONS:

DN	A	B	C	D	PN
10	3/8"	40	27	8	10
15	1/2"	45	29	10	10

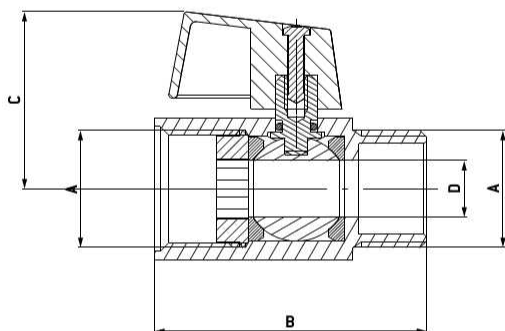
**PACKAGING:**

	3/8"	1/2"
CODE	77350003	77350004
PIECES PER BOX	5	5
PIECES PER CARTON	100	100