

BASIC

Valvola a sfera a passaggio totale
serie universale









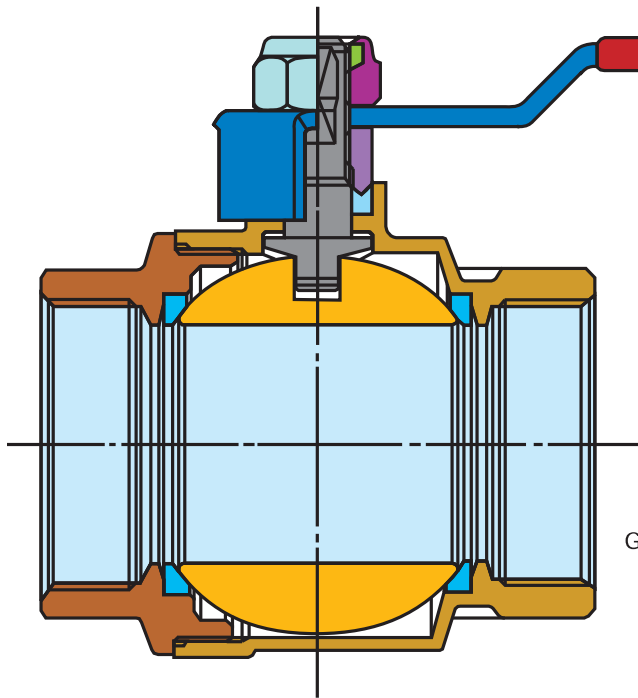
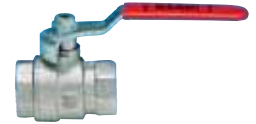

Full bore ball valve standard series



BASIC

Valvola a sfera a passaggio totale serie universale
Full bore ball valve standard series



CORPO / BODY	1	
MANICOTTO / END ADAPTER	2	
SFERA / BALL	3	
SEDI LATERALI / BALL GASKETS	4	
PERNO / STEM	5	
ANELLO ANTIFRIZIONE / THRUST WASHER	6	
GUARNIZIONE DI TENUTA SUPERIORE / STEM PACKING	7	
DADO / GLAND	8	
LEVA / HANDLE	9	
DADO AUTO-BLOCCANTE / SELF-LOCKING NUT	10	

SPECIFICA MATERIALI / MATERIAL SPECIFICATION

PARTICOLARI / COMPONENT	MATERIALI / MATERIAL	DESCRIZIONE / DESCRIPTION
 1 Corpo Body	CW 617 N UNI EN 12165 CW 617 N UNI EN 12165	Stampato da barra, nichelato Nickel-plated, forged brass
 2 Manicotto End adapter	CW 617 N UNI EN 12165 CW 617 N UNI EN 12165	Stampato da barra, nichelato Nickel-plated, forged brass
 3 Sfera Ball	CW 614 N UNI EN 12164 CW 614 N UNI EN 12164	Da barra, cromata Machined brass bar, chrome-plated
 4 Sedi laterali Ball gaskets	P.T.F.E. P.T.F.E.	Vergine Pure Teflon
 5 Perno Stem	CW 614 N UNI EN 12164 CW 614 N UNI EN 12164	Da barra Machined brass bar
 6 Anello antifrizione Thrust washer	P.T.F.E. P.T.F.E.	Vergine Pure Teflon
 7 Guarnizione di tenuta superiore Stem packing	P.T.F.E. P.T.F.E.	Vergine Pure Teflon
 8 Dado Gland	CW 614 N UNI EN 12164 CW 614 N UNI EN 12164	Da barra Machined brass bar
 9 Leva Handle	Acciaio zincato Steel Fe P02	Zincato / P.V.C. rosso Zinc-plated, red P.V.C. insulated
 9 Leva o farfalla Lever or T-handle	AL UNI5076 AL UNI5076	Alluminio rosso rivestito di poliuretano Red polyurethane-coated aluminium
 10 Dado auto-bloccante Self-locking nut	Acciaio 8G Zinc-plated 8G steel	Acciaio zincato Zinc-plated

CARATTERISTICHE

Serie standard, passaggio totale, filetti corti.
Tenuta perfetta a bassa e alta pressione.
Lunga durata senza manutenzione.

FILETTATURE

Estremità filettate UNI ISO 228/1.

IMPIEGHI

Le valvole a sfera **BASIC** sono adatte per l'uso con acqua calda e fredda, aria compressa, olii e idrocarburi in generale.

Per utilizzi speciali vedere le tabelle di compatibilità chimica.

PRESSIONE DI ESERCIZIO

Da PN 80 (1/4") a PN 16 (4").

Vedere diagramma pressione/temperatura.

LIMITI DI TEMPERATURA

-20°C + 140°C.

Vedere diagramma pressione/temperatura.

NOTE:

In accordo alla UNI EN 13828 in presenza di acque aggressive per la lega di ottone, in ottemperanza alla UNI EN ISO 6509, è necessario l'utilizzo della lega di ottone CW602N. La produzione è disponibile su richiesta.

Le valvole a sfera della serie BASIC sono realizzate in conformità alla EN 13828.

CHARACTERISTICS

Standard series, full bore, short threads.
Perfect tightness at low and high pressure.
Long life with no maintenance.

THREADS

Threaded ends UNI ISO 228/1.

USES

The **BASIC** ball valves are suitable for hot and cold water, compressed air, oils and hydrocarbons in general. For special uses please see the chemical resistance tables.

WORKING PRESSURE

From PN 80 (size 1/4") to PN 16 (size 4").

See pressure/temperature diagram

TEMPERATURE LIMITS

From -20°C to +140°C.

See pressure/temperature diagram

NOTE:

According to UNI EN 13828 in presence of water which could be aggressive for brass alloy, as agree with UNI EN ISO 6509 standard, is necessary the brass alloy CW602N. The manufacture is available on request.

BASIC ball valves are manufactured in accordance with EN 13828 standard.

Diagramma pressione/temperatura (prova eseguita con acqua) Pressure/temperature diagram (tested with water)



Diagramma perdite di carico Head loss diagram



BASIC

Valvola a sfera a passaggio totale serie universale
Full bore ball valve standard series

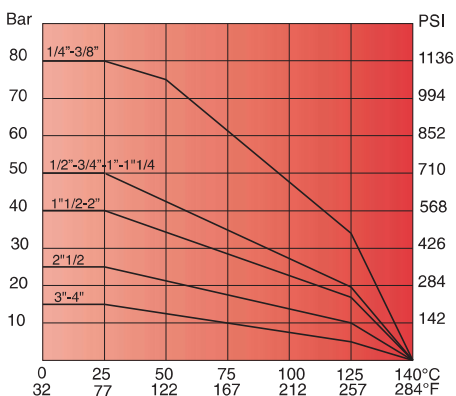
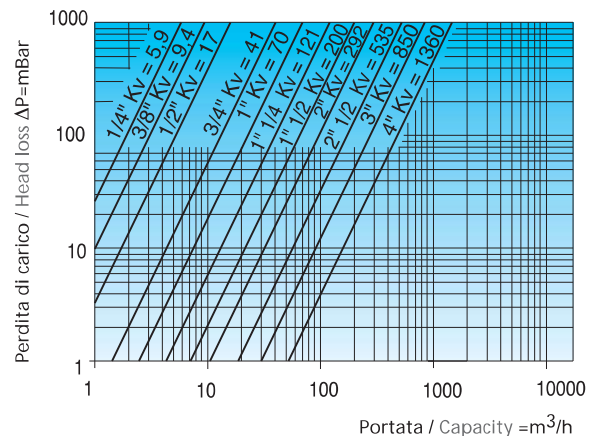
Art. S.0211 BASIC

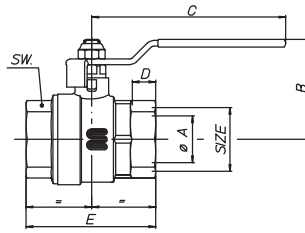
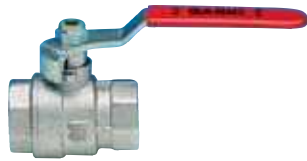

Su richiesta disponibile filettatura NPT.
Available on request NPT threads.

Valvola a sfera passaggio totale con leva ferro, femmina/femmina, nichelata.
Full bore valve with steel handle, female/female, nickel-plated.

SIZE	¼"	¾"	½"	¾"	1"	1¼"	1½"	2"	2½"	3"	4"
øA pass./bore	10	10	15	20	25	32	40	50	65	80	100
B mm	38	38	39,5	47,5	51,5	62	71	85,5	98,5	112,5	135
C mm	90	90	90	105	105	120	140	170	170	250	250
D mm	11	11,4	9,5	11	12,5	13,5	15,5	17,5	19,5	21	24,3
E mm	47,5	49,5	49	59	70	81	94	112	134	156	189
SW mm	17	21	25	31	38	47	54	66	83	97	124
Peso/Weight gr.	132	143	188	300	428	699	1125	1715	3090	5325	8960

Art. S.0212 BASIC

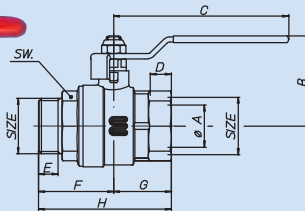

Valvola a sfera passaggio totale con leva ferro, maschio/femmina, nichelata.
Full bore valve with steel handle, male/female, nickel-plated.

SIZE	½"	¾"	1"	1¼"	1½"	2"				
øA pass./bore	15	20	25	32	40	50				
B mm	39,5	47,5	51,5	62	71	85,5				
C mm	90	105	105	120	140	170				
D mm	9,5	11	12,5	13,5	15,5	17,5				
E mm	9,7	10,7	11,7	13,2	14,7	16,7				
F mm	35	40,5	44,5	47,5	54,5	65				
G mm	24,5	29,5	35	40,5	47	56				
H mm	59,5	70	79,5	98	101,5	121				
SW mm	25	31	38	47	54	66				
Peso/Weight gr.	199	340	475	760	1154	1800				

Art. S.3212 BASIC

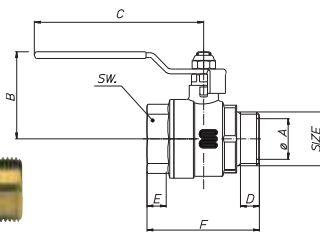
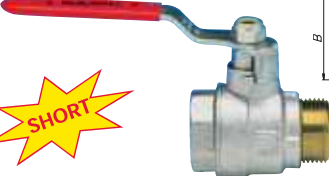

Valvola a sfera passaggio totale con leva ferro, maschio/femmina, nichelata.
Full bore valve with steel handle, male/female, nickel-plated.

SIZE	½"	¾"	1"	1¼"	1½"	2"				
øA pass./bore	15	20	25	32	39	48				
B mm	39,5	47,5	51,5	72	74	80				
C mm	90	105	105	120	140	170				
D mm	9,7	10,7	11,7	17	20	20				
E mm	9,5	11	12,5	13,5	15,5	17,5				
F mm	49	59	70	81	94	112				
SW mm	25	31	38	47	54	66				
Peso/Weight gr.	187	316	463	874	1120	1750				

Art. S.0213 BASIC

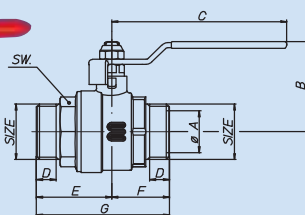
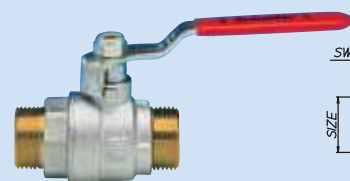

Valvola a sfera passaggio totale con leva ferro, maschio/maschio, nichelata.
Full bore ball valve with steel handle, male/male, nickel-plated.

SIZE	½"	¾"	1"	1¼"	1½"	2"				
øA pass./bore	15	20	25	32	39	48				
B mm	39,5	47,5	51,5	72	74	80				
C mm	90	105	105	120	140	170				
D mm	9,7	10,7	11,7	17	20	20				
E mm	35	40,5	44,5	47,7	54,5	65				
F mm	24,5	29,5	35	40,5	47,5	56				
G mm	59,5	70	79,5	97	110	125				
SW mm	25	31	38	47	54	66				
Peso/Weight gr.	213	333	451	755	1124	2010				